

MODEL CC3 COMBUSTIBLE CONCEALED SPRINKLER

4.2 and 5.6 K-factor Specific Application, Upright

For the First Time

6" to 60" Depth
Protection Available

Industry Leading

16' x 16' Spacing
For All Depths and
Construction Types

Now Allowing

the Use of CPVC in
Combustible Concealed
Spaces Up to 60" Depth



Features & Benefits:

- Complies with NFPA 13 for Combustible Concealed Spaces
- Specific Application Listing from 6" to 60" Depth
- Sprinkler Spacing up to 16 x 16 for All Construction Types
- Available in 4.2K and 5.6K Models
- Utilizes a 200°F 3mm Glass Bulb
- For Use in CPVC (wet) or Steel (wet or dry) Piping Sprinkler Systems
- UL Listed

The TYCO Model CC3 Combustible Concealed Sprinklers are quick response, upright, specific application sprinklers designed to provide protection of specific light hazard combustible, as well as non-combustible, concealed spaces requiring sprinkler protection. The Model CC3 Sprinklers comply with the criteria for the protection of combustible concealed spaces as described in NFPA 13.

The Model CC3 Sprinklers are designed for installation on BlazeMaster CPVC wet pipe systems and steel wet pipe or dry pipe sprinkler systems.

The Model CC3 Sprinklers are designed to be installed in the following arrangements for both wet CPVC and Steel:

4.2K

14 ft (4,3 m) maximum
between sprinklers

196 ft² (59,7 m²) maximum
coverage area

5.6K

16 ft (4,9 m) maximum
between sprinklers

256 ft² (78,0 m²) maximum
coverage area

6 inch (152,4 mm) minimum
clear space height.

60 inch (1524 mm) maximum
height from joist to joist and
84 inch (2134 mm) from
upper deck to ceiling.

60 inch (1524 mm) maximum
height for truss and bar joist.

Refer to Technical Data
Sheet TFP633 for specific
design criteria.

Typical Steel Pipe Installation

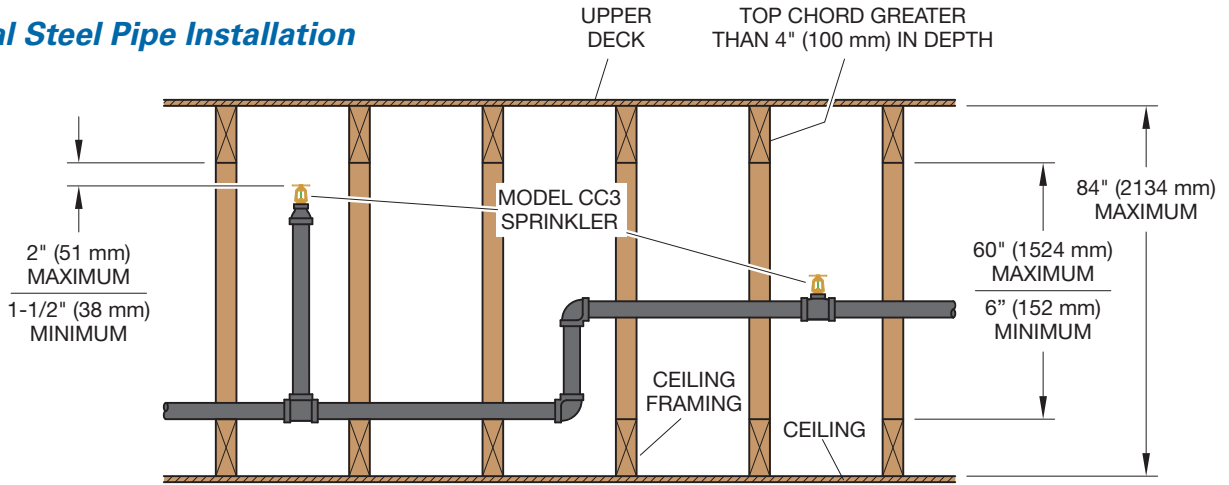

Typical CPVC Pipe Installation

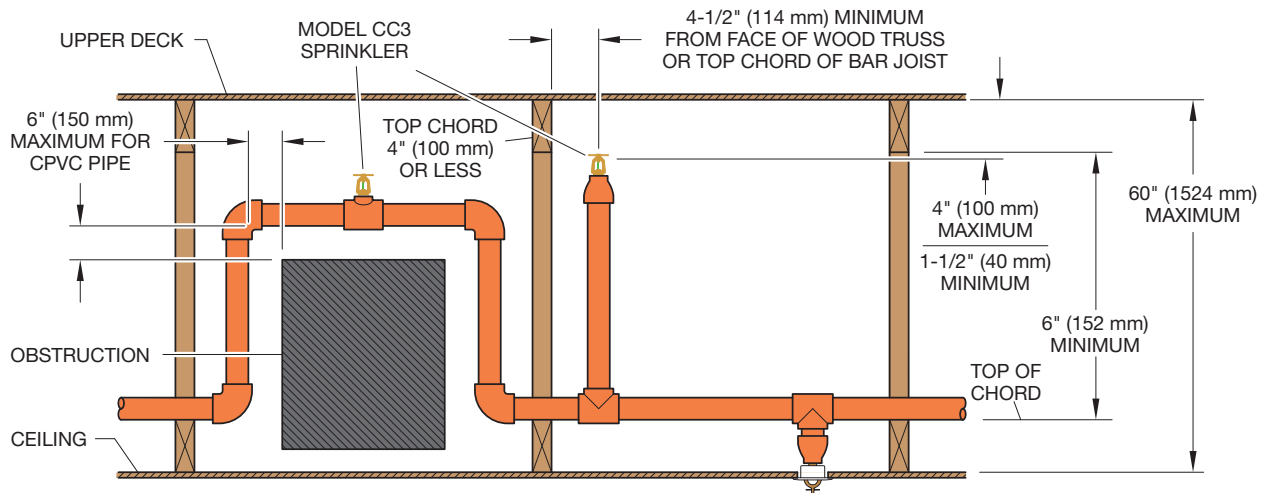

Specifications:
Model CC3 Combustible Concealed Sprinkler

Discharge Coefficient: $K=4.2$ gpm/psi^{1/2} (60,5 lpm/bar^{1/2}) / $K=5.6$ gpm/psi^{1/2} (80,6 lpm/bar^{1/2})

Pipe Thread Size: 1/2 inch NPT

Temperature Rating: 200°F (93°C)

Finish: Natural Brass

Part Numbers

TY2199, **4.2K** P/N: 51-311-1-200
 TY3199, **5.6K** P/N: 51-301-1-200

Sprinkler Wrench:

Specify: W-Type 6 Sprinkler Wrench,
 P/N 56-000-6-387

Always refer to the Technical Data Sheet TFP633 for complete description of all Listing criteria, design parameters, installation instructions, care and maintenance guidelines.

Tyco Fire Protection Products
www.tyco-fire.com

Technical Services - Phone: 800-381-9312
 Fax: 800-791-5500

All brand names, product names or trademarks belong to their respective owners. Tyco Fire Protection Products reserves the right to change product design and specifications without notice. Copyright © 2014 Tyco Fire Products LP. All rights reserved.